



HISTORIC RESOURCE INVENTORY FORM

NYS OFFICE OF PARKS, RECREATION
& HISTORIC PRESERVATION
P.O. BOX 189, WATERFORD, NY 12188
(518) 237-8643

OFFICE USE ONLY

USN: _____

IDENTIFICATION

Property name(if any) _____
Address or Street Location 12 Leitch Avenue
County Onondaga Town/City _____ Village/Hamlet: Skaneateles
Owner Joseph Viscomi Address 12 Leitch Avenue
Original use Single-family residence Current use Single-family residence
Architect/Builder, if known Edson D. Gillett and Jerry Shallish Date of construction, if known Ca. 1878
(roof) / Lucy A. Ellery

DESCRIPTION

Materials -- please check those materials that are visible

Exterior Walls:	<input type="checkbox"/> wood clapboard	<input checked="" type="checkbox"/> wood shingle	<input type="checkbox"/> vertical boards	<input type="checkbox"/> plywood	
	<input type="checkbox"/> stone	<input type="checkbox"/> brick	<input type="checkbox"/> poured concrete	<input type="checkbox"/> concrete block	
	<input type="checkbox"/> vinyl siding	<input type="checkbox"/> aluminum siding	<input type="checkbox"/> cement-asbestos	<input type="checkbox"/> other: _____	
Roof:	<input type="checkbox"/> asphalt, shingle	<input type="checkbox"/> asphalt, roll	<input type="checkbox"/> wood shingle	<input type="checkbox"/> metal	<input type="checkbox"/> slate (unknown)
Foundation:	<input checked="" type="checkbox"/> stone	<input type="checkbox"/> brick	<input type="checkbox"/> poured concrete	<input type="checkbox"/> concrete block	

Other materials and their location: No

Alterations, if known: See Continuation Sheet Date: _____

Condition: excellent good fair deteriorated

Photos

Provide several clear, original photographs of the property proposed for nomination. Submitted views should represent the property as a whole. For buildings or structures, this includes exterior and interior views, general setting, outbuildings and landscape features. Color prints are acceptable for initial submissions.

Please staple one photograph providing a complete view of the structure or property to the front of this sheet. Additional views should be submitted in a separate envelope or stapled to a continuation sheet.

Maps

Attach a printed or drawn locational map indicating the location of the property in relationship to streets, intersections or other widely recognized features so that the property can be accurately positioned. Show a north arrow. Include a scale or estimate distances where possible.

Prepared by: Yi-Hsin Lo address 106 West Sibley Hall

Telephone: (607) 255-4331 email _____ Date Fall 2007

(See Reverse)

PLEASE PROVIDE THE FOLLOWING INFORMATION

IF YOU ARE PREPARING A NATIONAL REGISTER NOMINATION, PLEASE REFER TO THE ATTACHED INSTRUCTIONS

Narrative Description of Property: Briefly describe the property and its setting. Include a verbal description of the location (e.g., north side of NY 17, west of Jones Road); a general description of the building, structure or feature including such items as architectural style (if known), number of stories, type and shape of roof (flat, gabled, mansard, shed or other), materials and landscape features. Identify and describe any associated buildings, structures or features on the property, such as garages, silos, privies, pools, gravesites. Identify any known exterior and interior alterations such as additions, replacement windows, aluminum or vinyl siding or changes in plan. Include dates of construction and alteration, if known. Attach additional sheets as needed.

See Continuation Sheet

Narrative Description of Significance: Briefly describe those characteristics by which this property may be considered historically significant. Significance may include, but is not limited to, a structure being an intact representative of an architectural or engineering type or style (e.g., Gothic Revival style cottage, Pratt through-truss bridge); association with historic events or broad patterns of local, state or national history (e.g., a cotton mill from a period of growth in local industry, a seaside cottage representing a locale's history as a resort community, a structure associated with activities of the "underground railroad."); or by association with persons or organizations significant at a local, state or national level. Simply put, why is this property important to you and the community. Attach additional sheets as needed.

See Continuation Sheet

Narrative Description of Property:

This house is situated on the east side of Leitch Avenue near the intersection of Leitch Avenue and E. Genesee Street. Several Similar Italianate- style houses were built at the same period of time along the east side of Leitch Avenue.

This two-story house has irregular massing with a low- pitched roof. Many characteristics of this house are similar to what the McAlesters identify, in their book *A Field Guide to American Houses*, as the Italianate Style. This style is often associated with houses that were built around 1840 to 1885; it is known for its wide overhanging eaves with cornice brackets under the eave. This house has a three-story tower located on the west façade. The main entrance, which has a typical Italianate-style porch and door, is located on the southeast facade of the tower. Several narrow single and paired windows with segmental arches and full arches are found on the first and second story. A one-story bay window is placed on the west (front) façade, and another two additional one-story bay windows and two- story bay window project out of the south façade. A one-story and a two-story wing, whose first floors are the garage, are attached to the north façade. These wings were apparently added later after this house was built as they have thinner brackets and different style windows. The exterior of the house is clad in wood shingles. An open spiral staircase in the front hall is also the feature of the Italianate-style house. There are six openings off from the dinning room, which is the center of the down stairs floor plan.

This house has experienced several major alterations reflecting the changing space needs and functions. The addition of the two-story wing consisting of a garage with a bedroom overhead was probably completed as of January 12, 1956. Another one-story garage with hipped roof was probably added between 1994 and 2001. The bracket decorations under the eave are similar on these two garages, so they might be either made by machine or added by the same craftsman. The two-story rear wing, which extended a dining room and a bedroom, was added at an unknown date. There is no outbuilding on the property.

Narrative Description of Significance:

This land was originally a portion of Military Lot #36. The land was owned by Jediah Sauger after the Revolutionary War. On the 1856 map, this lot subdivided into smaller parcels, and this land was a portion of Lot #11. The property has been sold several times and was once owned by George F. Leitch and Catherine Kellogg Leitch. The Leitch Avenue was name for D. Kellogg Leitch, who was the son of George F. Leitch and Catherine Kellogg Leitch, because he donated the land to widen this

north-south road. D. Kellogg Leitch and Lavinia I. Leitch (his wife) inherited the parcel of land in 1872, and sold the land to William G. Ellery and Lucy A. Ellery (his wife) for \$125 in 1882.

William G. Ellery authorized Edson D. Gillett, who worked at his father's (Alonzo Gillett) brickyard on Fennel Street in Skaneateles for 20 years, to build the house in 1878. Jerry Shallish, who was the house owner of 10 Leitch Street, also was engaging to roof it. After the Ellerys lived there for 43 years, Lucy A. Ellery sold the property to Alfred F. Presley and Laura G. Presley (his wife) in 1921, and moved to live with her granddaughter Mrs. Charles Burnett in Spencerport, N.Y. In 1943, several years after Alfred F. Presley passed away (1928), Laura G. Presley sold the property to J. Wilson Cumming and Esther B. Cumming. The property was sold again to William S. Squire and Nancy H. Squire in 1949. In 1951, William A. Lake and Louise H. Lake (his wife) bought the property and added a two-story wing on the north façade. They sold the property to Paul E. Mullins and Florence P. Mullins in 1964, and two years later they bought it back, and sold it again in 1966. The property had transferred four times during 1966 to 1979, and was sold to James L. Higbee and Ann G. Higbee (his wife). Mrs. Higbee, who was a vice president at Eric Mower and Associates Public Relations Service, is successful at her job. Mr. and Mrs. Higbee sold the house to present owner at 1987.

Sources:

McAlester, Virginia and Lee, A Field Guide to American Houses. New York: Alfred A Knopf, 1996.

Skaneateles Historical Society, 12 Leitch Avenue, Ellery, Gillett, and Higbee family file.

Onondaga County Deed Records, Onondaga Court House, Syracuse. New York

Map:

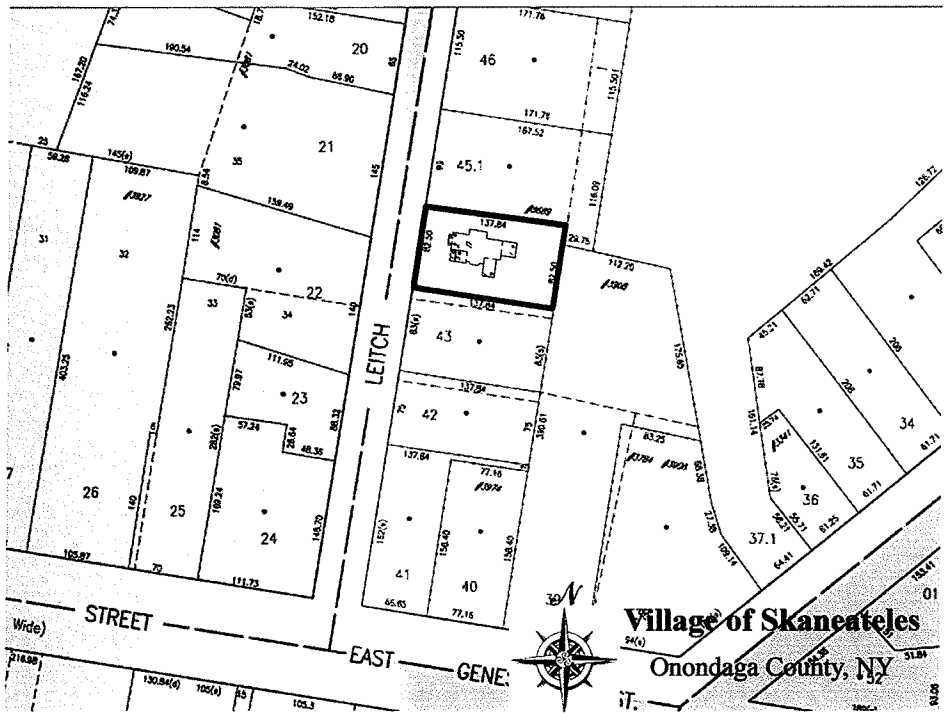

Photo:



West facade