



HISTORIC RESOURCE INVENTORY FORM

NYS OFFICE OF PARKS, RECREATION
& HISTORIC PRESERVATION
P.O. BOX 189, WATERFORD, NY 12188
(518) 237-8643

OFFICE USE ONLY
USN: _____

IDENTIFICATION

Property name(if any) _____
Address or Street Location 10 Leitch Avenue
County Onondaga Town/City _____ Village/Hamlet: Skaneateles
Owner John M. O'Sullivan Jr. and Elizabeth O'Sullivan Address 10 Leitch Avenue
Original use Single-family residence Current use Single-family residence
Architect/Builder, if known Unknown Date of construction, if known Ca. 1973

DESCRIPTION

Materials -- please check those materials that are visible

Exterior Walls:	<input type="checkbox"/> wood clapboard	<input type="checkbox"/> wood shingle	<input type="checkbox"/> vertical boards	<input type="checkbox"/> plywood	
	<input type="checkbox"/> stone	<input checked="" type="checkbox"/> brick	<input type="checkbox"/> poured concrete	<input type="checkbox"/> concrete block	
	<input type="checkbox"/> vinyl siding	<input type="checkbox"/> aluminum siding	<input type="checkbox"/> cement-asbestos	<input type="checkbox"/> other: _____	
Roof:	<input type="checkbox"/> asphalt, shingle	<input type="checkbox"/> asphalt, roll	<input type="checkbox"/> wood shingle	<input checked="" type="checkbox"/> metal	<input type="checkbox"/> slate
Foundation:	<input checked="" type="checkbox"/> stone	<input type="checkbox"/> brick	<input type="checkbox"/> poured concrete	<input type="checkbox"/> concrete block	

Other materials and their location: A garage is located to the northwest of the house

Alterations, if known: See Continuation Sheet Date: _____

Condition: excellent good fair deteriorated

Photos

Provide several clear, original photographs of the property proposed for nomination. Submitted views should represent the property as a whole. For buildings or structures, this includes exterior and interior views, general setting, outbuildings and landscape features. Color prints are acceptable for initial submissions.

Please staple one photograph providing a complete view of the structure or property to the front of this sheet. Additional views should be submitted in a separate envelope or stapled to a continuation sheet.

Maps

Attach a printed or drawn locational map indicating the location of the property in relationship to streets, intersections or other widely recognized features so that the property can be accurately positioned. Show a north arrow. Include a scale or estimate distances where possible.

Prepared by: Yi-Hsin Lo address 106 West Sibley Hall

Telephone: (607) 255-4331 email _____ Date Fall 2007

(See Reverse)

PLEASE PROVIDE THE FOLLOWING INFORMATION

IF YOU ARE PREPARING A NATIONAL REGISTER NOMINATION, PLEASE REFER TO THE ATTACHED INSTRUCTIONS

Narrative Description of Property: Briefly describe the property and its setting. Include a verbal description of the location (e.g., north side of NY 17, west of Jones Road); a general description of the building, structure or feature including such items as architectural style (if known), number of stories, type and shape of roof (flat, gabled, mansard, shed or other), materials and landscape features. Identify and describe any associated buildings, structures or features on the property, such as garages, silos, privies, pools, gravesites. Identify any known exterior and interior alterations such as additions, replacement windows, aluminum or vinyl siding or changes in plan. Include dates of construction and alteration, if known. Attach additional sheets as needed.

See Continuation Sheet.

Narrative Description of Significance: Briefly describe those characteristics by which this property may be considered historically significant. Significance may include, but is not limited to, a structure being an intact representative of an architectural or engineering type or style (e.g., Gothic Revival style cottage, Pratt through-truss bridge); association with historic events or broad patterns of local, state or national history (e.g., a cotton mill from a period of growth in local industry, a seaside cottage representing a locale's history as a resort community, a structure associated with activities of the "underground railroad."); or by association with persons or organizations significant at a local, state or national level. Simply put, why is this property important to you and the community. Attach additional sheets as needed.

See Continuation Sheet.

Narrative Description of Property:

This house is situated on the east side of Leitch Avenue near the intersection of Leitch Avenue. Several similar Italianate-style houses were built at the same period of time along the east side Leitch Avenue.

This two-story masonry residence has square massing and a flat roof. The house has four bays on west (front) façade and the main entrance is located in the mid-northern bay. Many characteristics of the house are similar to what the McAlesters identify, in their book *A Field Guide to American Houses*, as the Italianate-style. This style is known for its wide overhanging eaves and cornice, brackets under the eave. In addition, this house has large two-over-two double-hang segmental windows with shutters on first and second stories. A single-story, full-width porch supported by piers is found on the west (front) façade. The porch has a balustrade and flat roof. A two-story bay window projects from the south façade. Another entrance is found on the north side of the porch near the garage. Two interior brick chimneys are placed atop the roof. A single-story flat-roofed porch, which has been enclosed by shingle siding, is located on the east (rear) façade. A single car garage clad in shingles is located to the northeast side of the residence.

It is hard to alter an Italianate-style house, and is likely to be part that most altered. The rear porch was probably enclosed in 1873. The garage to the northeast of the house was probably added at 1939.

Narrative Description of Significance:

The house was constructed and once owned by Jerry Shallish, who moved to Village Skaneateles from Somersetshire, England with his parents when he was seven in 1838. Jerry was involved in the plumbing and tinning business for 71 years, and was once the eldest person in the village. Jerry made his own plans and built this house ca. 1873. He lived in the house for about 53 years. Five years before he died at 95, he turned over the land and house to Emma L. Shallish, who might be Jerry's niece. Emma sold the property to Elizabeth F. Snyder two months later after Jerry's death. Elizabeth mortgaged the house to Skaneateles Saving Bank for four thousand dollars in 1926. After ten years, Elizabeth F. Snyder sold the property to John L. Shultz, whose son was a Senator in the New York State Senate. Senator Searles G. Shultz and his wife, Dorothy H. Shultz, inherited the property when their father passed away in 1964. Senator Shultz had a car accident and died in 1976. Prior to his death, the couple sold the property to John W. Howard and his wife Ruth F. Howard. Ruth inherited the property in 1979, and sold it to

Continuation Sheet, Page 2
10 Leitch Avenue
Skaneateles, New York

the present property owners John M. O' Sullivan Jr. and Elizabeth O' Sullivan in 2006.

Sources:

McAlester, Virginia and Lee, A Field Guide to American Houses. New York: Alfred A knopf, 1996.

Skaneateles historical society, 10 Leitch Avenue, Shallish and Shultz family file.

Onondaga County Deed Records, Onondaga Court House, Syracuse. New York

Map:

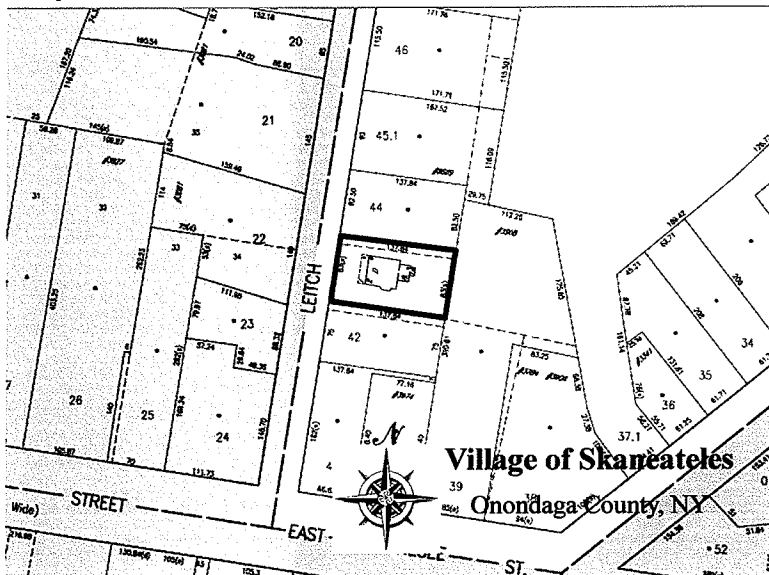
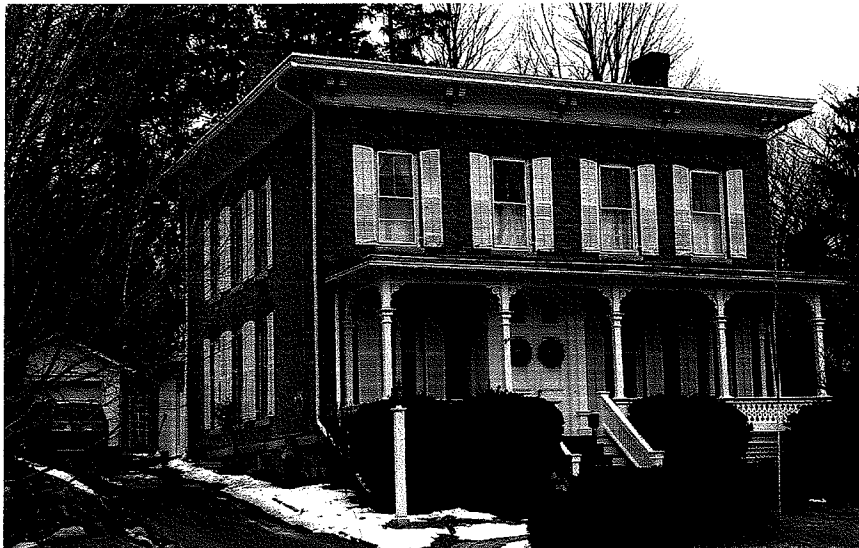

Photo:



West facade